



APL 404

# QUICK REFERENCE CARD SPRAYPEN APPLICATION KIT – CO-DELIVERY



## PART 1 – PREPARE DISPOSABLE APPLICATOR DEVICE AND APPLICATOR UNIT

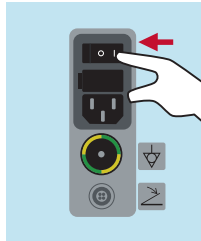

1. Turn unit ON and connect Foot Switch

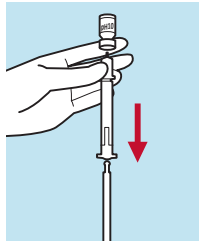

2. Place 21g needle just inside pH 10 vial, draw fluid into 1 ml syringe\*

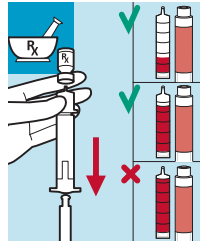

3. Prepare Co-Delivery solution to less or equal to sealant/matrix

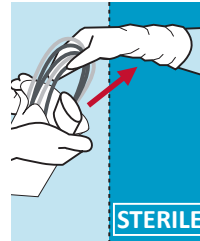

4. Transfer disposable applicator + PH paper to sterile area

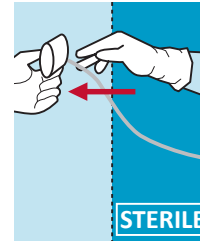

5. Transfer syringe holder out of sterile area

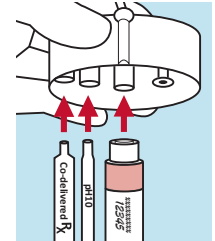

6. Insert pH 10, sealant/matrix and co-delivery syringes into syringe holder

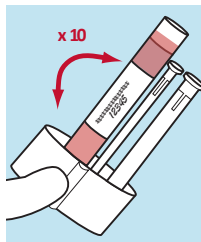

7. Matrix: rotate syringe holder back and forth x10\*

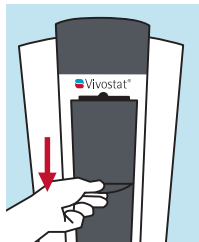

8. When indicated in display, open shield

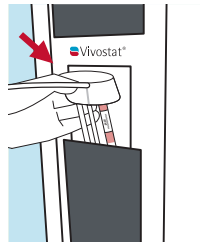

9. Insert and position syringe holder

Using APL 404 without co-delivery: take care that pH10 syringe is positioned straight and not in co-delivery cavity.

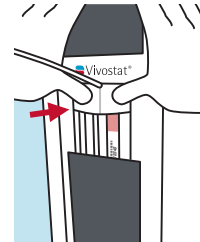

10. Press syringe holder into cavity using two fingers

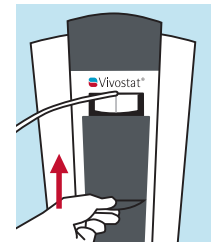

11. Close shield

## PART 2 – LOAD SYRINGES, PRIME AND INITIATE APPLICATION

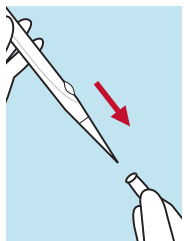

1. Take cap off Spraypen



2. Press button to start loading syringes

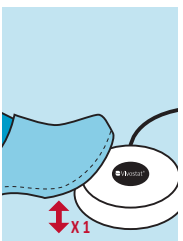

3. Press foot switch once to prime

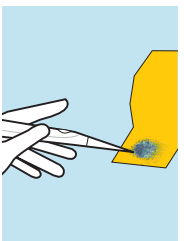

4. Point to lower corner of pH-paper while autopriming

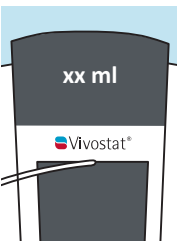

5. Autoprime stops automatically and ml + spray mode is displayed

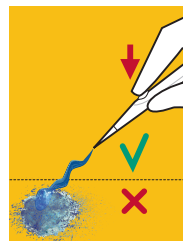

6. Verify correct mixture on pH-paper (from liquid to viscous in 10-30 sec.)\*

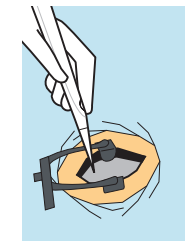

7. Ready for application

## ADDITIONAL APPLICATION TIPS

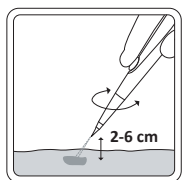

Use circular movements in a 2-6 cm spray distance

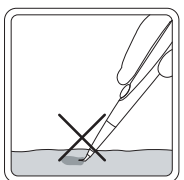

Do NOT poke tissue and bend Spraypen tip

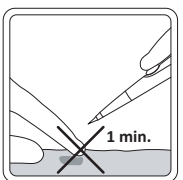

Avoid touching the applied substance immediately after application



If apusing application +5 minutes, put cap on Spraypen

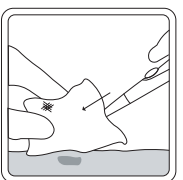

Remove cap and wipe tip of Spraypen prior to reapplying

## \* CAUTION:

1.2: To avoid air bubbles impacting mixture negatively do **NOT** push needle to the end of pH 10 vial.

1.7: Follow step carefully for platelets not to settle at bottom. They are essential for healing. If +30 min. pass after rotating, rotate again: press button on top of Applicator Unit for +4 sec., take out syringe holder, rotate and follow step 1.7-1.11.

2.6: If mixture do not turn viscous, press button on top of Applicator Unit for +4 sec. and verify syringe holder is placed correctly and follow step 1.7-1.11.

THIS QRC NEED TO BE READ IN CONJUNCTION WITH THE PRODUCT IFU AND MACHINE MANUAL.

For IFUs and manuals, QRC language versions and much more, please visit our website: [www.vivostat.com/application-now](http://www.vivostat.com/application-now)



Vivostat A/S  
Borupvang 2  
3450 Allerød  
Denmark

+45 8880 8400  
info@vivostat.com  
www.vivostat.com