



APL 400

# QUICK REFERENCE CARD ENDOSCOPIC APPLICATION KIT



## PART 1 – PREPARE DISPOSABLE APPLICATOR DEVICE AND APPLICATOR UNIT

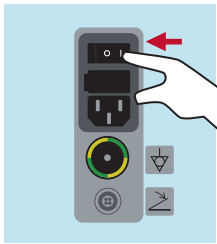

1. Turn unit ON and connect Foot Switch

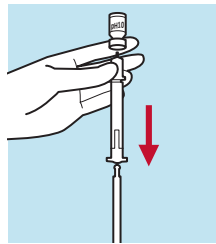

2. Place 21g needle just inside pH 10 vial, draw fluid into 1 ml syringe\*

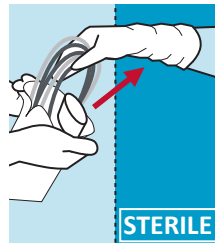

3. Transfer disposable applicator + PH paper to sterile area

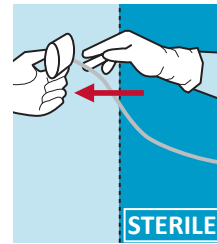

4. Transfer syringe holder out of sterile area

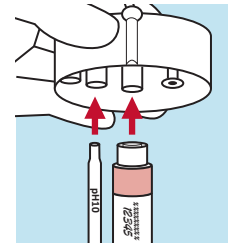

5. Insert pH 10 and sealant/matrix syringes into syringe holder

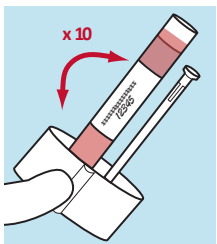

6. For matrix: rotate syringe holder back and forth 10 times\*

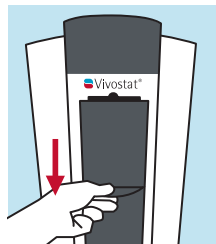

7. When indicated in display, open shield

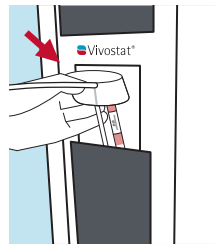

8. Insert and position syringe holder

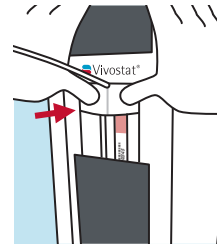

9. Press syringe holder into cavity using two fingers

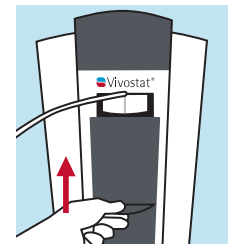

10. Close shield

## PART 2 (OPTIONAL) – LOAD CATHETER IN STERILISED APPLICATOR HANDLE

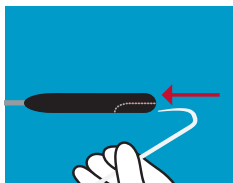

1. Place endoscopic catheter tip at the end of handle

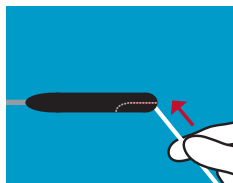

2. Load and push endoscopic catheter entirely through



3. Adjust endoscopic catheter for the right position – all angles are possible

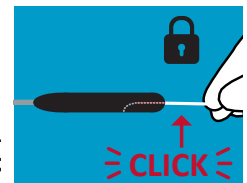

4. To lock position push catheter up until it "clicks"

Vivostat Handles (AZ 220, GM 220 and VS 220) is supplied non-sterile and must be sterilised according to standard hospital procedures before use. If no standard procedure is available, we recommend steam sterilisation at 134°C for 5 minutes.

## PART 3 – LOAD SYRINGES, PRIME AND INITIATE APPLICATION



1. Press button to start loading syringes

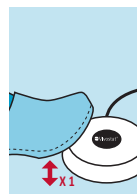

2. Press foot switch once to prime

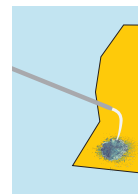

3. Point to lower corner of pH-paper while auto-priming



4. Auto-priming stops automatically and ml + spray mode is displayed



5. Verify correct mix on pH-paper (from liquid to viscous in 10-30 sec.)\*

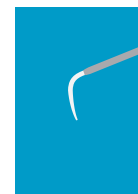

6. Ready for application

For Obsidian® ASG and Obsidian® RFT please also see specific Application Guides.

### \* CAUTION:

1.2: To avoid air bubbles impacting mixture negatively do **NOT** push needle to the end of pH 10 vial.

1.6: Follow step carefully for platelets not to settle at bottom. They are essential for healing. If +30 min. pass after rotating, rotate again: press button on top of Applicator Unit for +4 sec., take out syringe holder, rotate and follow step 1.6-1.10.

3.5: If mixture do not turn viscous, press button on top of Applicator Unit for +4 sec. and verify syringe holder is placed correctly and follow step 1.6-1.10.

THIS QRC NEED TO BE READ IN CONJUNCTION WITH THE PRODUCT IFU AND MACHINE MANUAL.

For IFUs and manuals, QRC language versions and much more, please visit our website: [www.vivostat.com/application-now](http://www.vivostat.com/application-now)



Vivostat A/S  
Borupvang 2  
3450 Allerød  
Denmark

+45 8880 8400  
[info@vivostat.com](mailto:info@vivostat.com)  
[www.vivostat.com](http://www.vivostat.com)