



Vivostat® PRF Preparation Kit

Quick Reference Card



PRO 800 Series

Local language versions are available for download on www.vivostat.com/qrcs

PART 1 – PREPARATION BEFORE PATIENT INVOLVEMENT (approx. 1 minute)

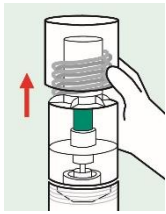

1. Remove outer lid

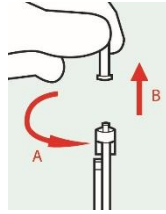

2. Remove cap from tube

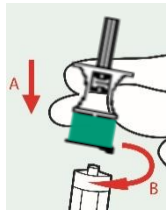

3. Open snap cap, screw spike on tube, remove spike cap

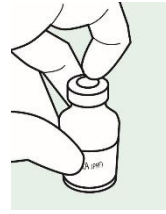

4. Remove citrate cap

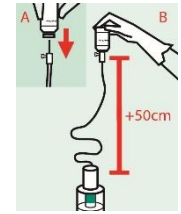

5. Flip citrate, pierce with spike and empty vial

PART 2 – DRAW BLOOD FROM THE PATIENT (approx. 5 minutes)

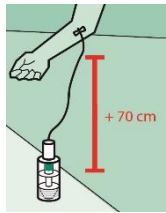

1. Secure vascular access and draw 120 ml blood

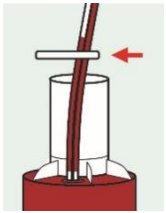

2. When prep unit is filled, clamp tube

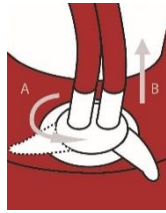

3. Turn to close valve properly and remove tube



4. Clean valve with sugi swabs

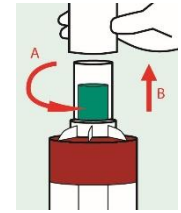

5. Remove lid



6. Take syringe, add patient ID and remove lid

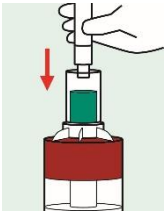

7. Insert syringe in prep unit

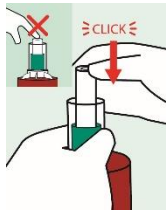

8. Click into place without pressing syringe plunger

To avoid leakage and machine errors be careful:

- 1) Not to use too high pressure on blood flow, when filling prep unit
- 2) Not to overfill prep unit
- 3) To close and clean valve carefully

PART 3 – PROCESS THE PATIENT'S BLOOD (approx. 25 minutes)

Turn ON Processor Unit on the back



1. Press button to open shield

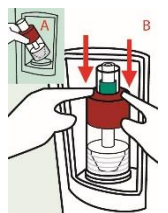

2. Place prep unit securely



3. Close shield, press button and processing starts

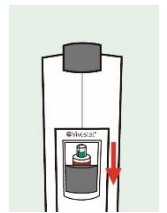

4. When complete, take out prep unit

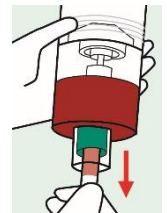

5. Flip prep unit and remove syringe

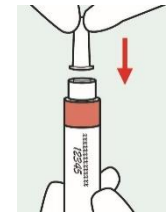

6. Put on cap

Vivostat® PRF is now ready-to-use and can be applied with the Vivostat® Applicator. Follow separate Vivostat® PRF Application Kit - Quick Reference Card.